

Hard Disc Shredder JBF HD 15/40 + 20/40

Shredding system JBF HD for hard discs and other data carrier, designed for flexible and mobile applications.

This type of shredding machine is designed for the shredding of hard discs, CD/DVD, video tapes, typewriter ribbon, retaining tape etc. With its reduced overall width of 760 mm it was designed to pass through standard doors.

18,5 mm knife width cares for small particle sizes and thus for more data security. The 3 kW drive with gear motor allows high cutting performance by its enormous torque. A low shaft speed of 11 rpm avoids sparking inside the cutting unit.

Secured feeding of material into the running shredder through special funnel with electrical safety switch according to the latest security regulations. Max. size of parts: approx. 150 x 200 x 40 mm (l x w x h). Feeding of larger parts is possible when shredder is stopped, lid closed and with manual machine start (old 5,5" hard discs with max. height 44 mm, DVD stack on spindle, PET bottles, cans etc.).

Auto reverse at overload with automatic restart. Machine stops after triple reverse. By direct drive of cutting shafts drive chains are not needed. Thus less maintenance requested along with low dust sensitivity.

Basic frame for 120 l container. Space-saving location of electrical cabinet, integrated inside machine frame.



Picture: JBF HD 15/40 with 120 l container (container not part of the standard delivery scope)



Feeding channel for manual feeding of hard discs



Chassis for 120 l container

Hard Disc Shredder JBF HD 15/40 + 20/40



Before and after shredding with JBF HD 15/40 or JBF HD 20/40

Machine on guidable rollers

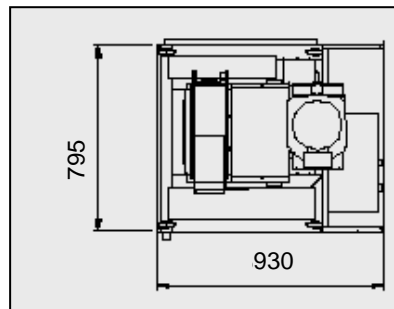
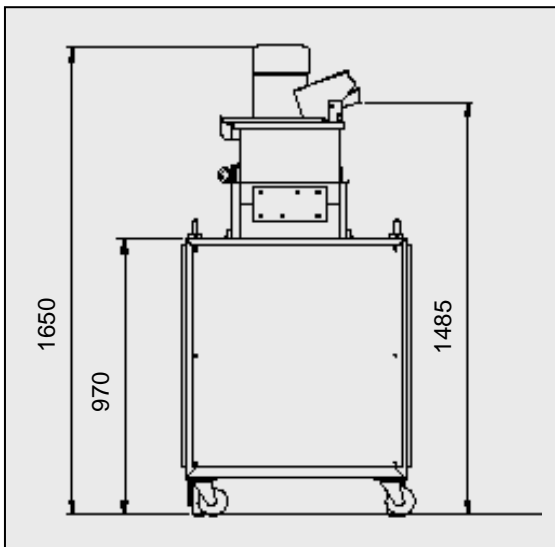

Pictures: JBF HD 15/40, measurements in mm

Technical Data:	JBF HD 15/40	JBF HD 20/40
Knife width	18,5 mm	19,7 mm
Cutting zone	appr. 150 x 400 mm	appr. 200 x 400 mm
Cutting speed	appr. 11 rpm	appr. 11 rpm
Container volume	120 l	120 l
Power supply	400 V / 50 Hz / 3 phases 16 A	400 V / 50 Hz / 3 phases 16 A
Connected load	S1: 3 kW, S6-40%: 4 kW	S1: 3 kW, S6-40%: 4 kW
Throughput	depending on size and execution of hard discs	
Measurements / Weight :		
Length	appr. 930 mm	
Width	appr. 795 mm	
Total height	appr. 1650 mm	
Insertion height	appr. 1485 mm	
Machine weight	appr. 600 kg	appr. 700 kg