

## Large Document Shredder 16.50 S

High-performance large document shredder with a conveyor belt feed from the receiving table to the cutting mechanism

# Large Document Shredder 16.50 S



High-power, thermally protected geared electric motor (7.5 kW) and stable drive

Rugged, wear-resistant cutting rollers made from high-grade steel for optimum cutting performance

500 mm working width; suitable for all standard computer formats



## Space-saving solution

- Can be installed next to a wall
- Container is removed from the operator side

## Simple operation

- Audible “container full” signal
- Accompanying visual display for operator and cutting process is halted

## Standard safety equipment

- Wide EMERGENCY STOP BAR on receiving table for immediate stop in an emergency
- Lockable master switch and key switch
- Safety switch to stop machine if container is not in place
- Motor protection device with thermosensor and overload relay

## Mobile container

- Supplied as standard equipment
- Capacity 450 litres
- Ergonomic handle design for ease of handling
- Fold-down front panel for effortless removal of shredded material



## Useful add-on: Dust Extractor

- Standard design allows for connection of a dust extractor
- Appreciable improvement in air quality and working conditions
- Space-saving, mobile positioning next to the shredder



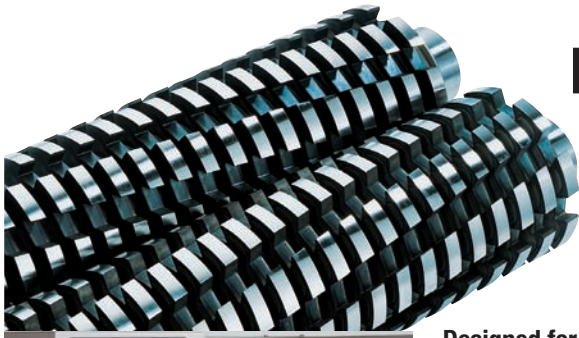

# Heavy Duty Shredder 16.50 S



## Designed for ease of operation

- Clearly laid out, rugged soft-touch keypad
- Audible and visual (LED) status displays
- Lockable master switch and key switch to prevent unauthorised use

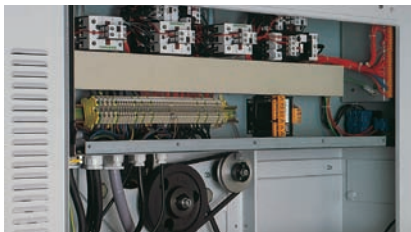

## Trouble-free operation

- All system functions are microprocessor-controlled
- Automatic reverse and restart in case of overload



## Large feed table with integral conveyor belt

- Generously sized feed table for controlled, fatigue-free, safe and rapid loading
- Cutting mechanism readily accessible for maintenance



## Comprehensive safety features

- Extensive safety systems provided for all functions to protect the operator and the machinery
- VDE / GS approved and certified



Convenient and fully-automatical workflow



Ensures a maximum of operation safety



Ensure highest user friendliness



Optimized interaction of the several drive parts



## Shipping

- Packed in wooden crate
- Dimensions L x W x H  
1,770 x 1,320 x 1,210 mm
- Transport weight 785 kg

## Large Document Shredder 16.50 S

Security class	DIN 32757-1	3	2	2
Size of shreds	mm	6 x 50	7.8 x 55	11.8 x 55
Shredding capacity <sup>1</sup>	sheets	300-330	350-420	400-550
Shredding capacity <sup>2</sup>	kg/h	330-380	380-430	430-480
Cutting speed	approx. m/sec	0.24	0.24	0.24
Working width	approx. mm	500	500	500
Collecting sack volume	l	450		
Filled weight <sup>3</sup>	kg	40-55		
Sound level	dBA	74		
Power supply	Volt	400 / 3ph		
Motor power	kW	7.5		
Dimensions L x W x H	mm	1,950 x 1,200 x 1,550		
Weight	kg	726		

<sup>1</sup> based on 70 g/m<sup>2</sup> A4 paper. Sheet capacities vary depending on quality, weight, grain of paper and sufficient power supply. It may be lower if the voltage is below the rated/nominal value.

<sup>2</sup> depending on feeding, material and power supply, with cutters in mint condition

<sup>3</sup> depending on material and cutting width

**Installation Instructions**  
**intimus 16.50 S / Heavy Duty Shredder**  
 Scale 1:40

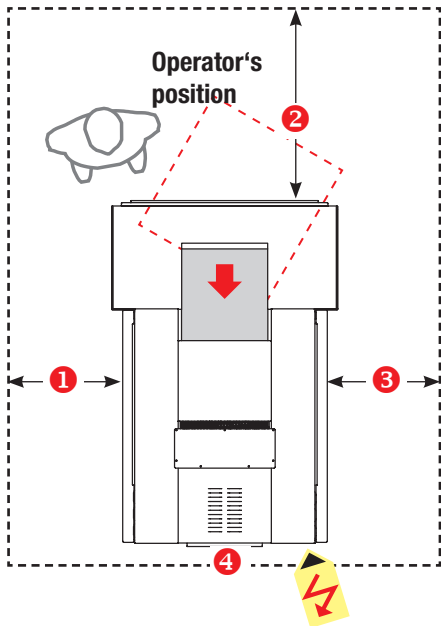

Dimensions	mm
① Length	1,950
② Height	1,550
③ Inlet height or desk height	1,200
④ Width	1,200

Required space / distances	mm
① min. 600	③ min. 600
② min. 1,000	④ min. 100



**Position of controls**



**Power Supply 3 Phase**

- Power lead = 3.15 m
- 400-415 V / 50 Hz supplied with Cekon CEE 32 A plug, 5-pin
- ...other voltages on request

**Required Fusing by customer**

- Miniature Circuit Breaker with tripping characteristic C
- or Fuse type gL / gG, coordination type 1 according to IEC / EN 60947-4-1

400-415 V / 50 Hz = 35 A slow blow  
 220-230 V / 50-60 Hz = 40 A slow blow  
 200 V / 50-60 Hz = 63 A slow blow

